

Typical DESA Kerosene Forced Air

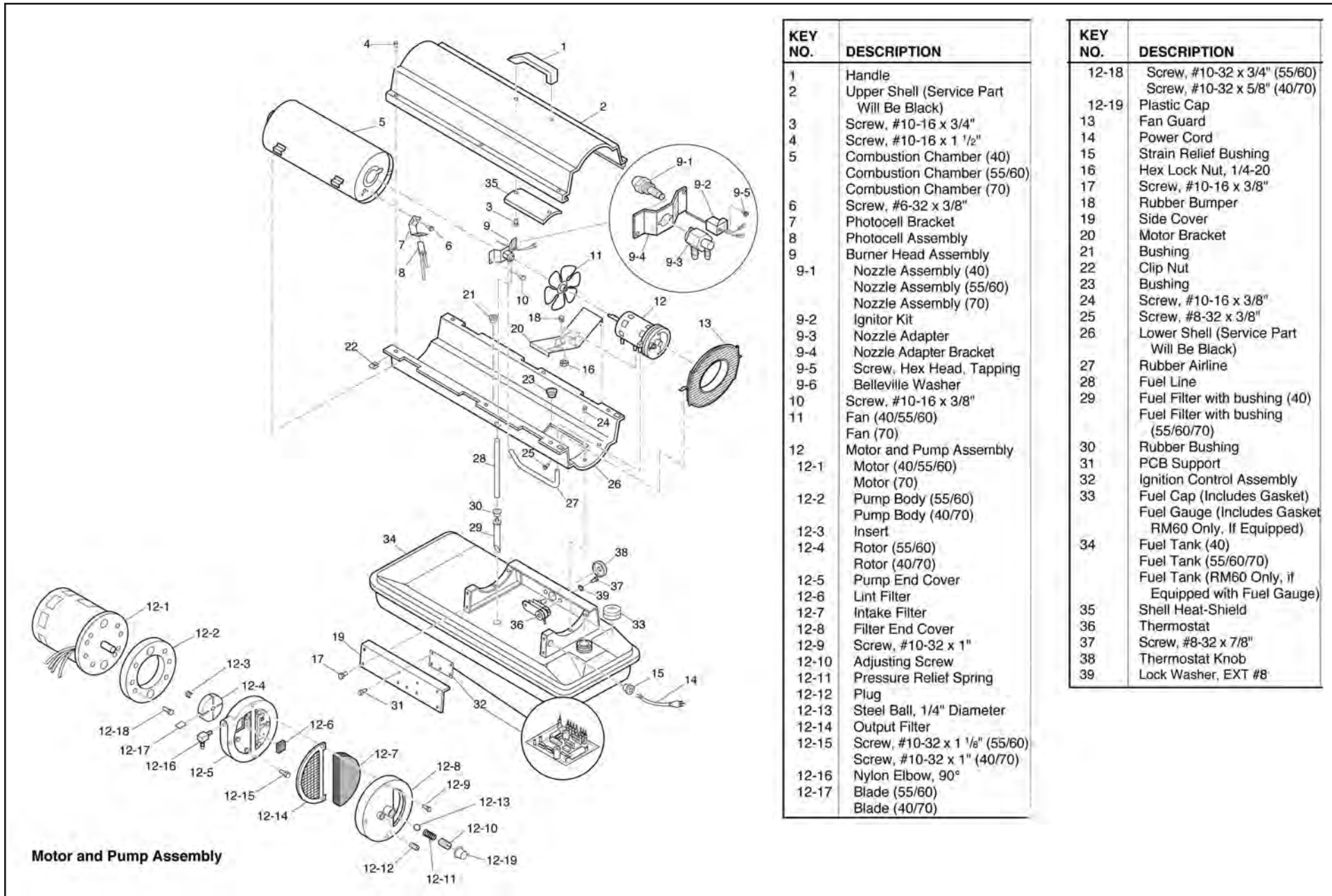

KEY NO.	DESCRIPTION
1	Handle
2	Upper Shell (Service Part Will Be Black)
3	Screw, #10-16 x 3/4"
4	Screw, #10-16 x 1 1/2"
5	Combustion Chamber (40) Combustion Chamber (55/60) Combustion Chamber (70)
6	Screw, #6-32 x 3/8"
7	Photocell Bracket
8	Photocell Assembly
9	Burner Head Assembly
9-1	Nozzle Assembly (40) Nozzle Assembly (55/60) Nozzle Assembly (70)
9-2	Ignitor Kit
9-3	Nozzle Adapter
9-4	Nozzle Adapter Bracket
9-5	Screw, Hex Head, Tapping
9-6	Belleville Washer
10	Screw, #10-16 x 3/8"
11	Fan (40/55/60) Fan (70)
12	Motor and Pump Assembly
12-1	Motor (40/55/60) Motor (70)
12-2	Pump Body (55/60) Pump Body (40/70)
12-3	Insert
12-4	Rotor (55/60) Rotor (40/70)
12-5	Pump End Cover
12-6	Lint Filter
12-7	Intake Filter
12-8	Filter End Cover
12-9	Screw, #10-32 x 1"
12-10	Adjusting Screw
12-11	Pressure Relief Spring
12-12	Plug
12-13	Steel Ball, 1/4" Diameter
12-14	Output Filter
12-15	Screw, #10-32 x 1 1/8" (55/60) Screw, #10-32 x 1" (40/70)
12-16	Nylon Elbow, 90°
12-17	Blade (55/60) Blade (40/70)

KEY NO.	DESCRIPTION
12-18	Screw, #10-32 x 3/4" (55/60) Screw, #10-32 x 5/8" (40/70)
12-19	Plastic Cap
13	Fan Guard
14	Power Cord
15	Strain Relief Bushing
16	Hex Lock Nut, 1/4-20
17	Screw, #10-16 x 3/8"
18	Rubber Bumper
19	Side Cover
20	Motor Bracket
21	Bushing
22	Clip Nut
23	Bushing
24	Screw, #10-16 x 3/8"
25	Screw, #8-32 x 3/8"
26	Lower Shell (Service Part Will Be Black)
27	Rubber Airline
28	Fuel Line
29	Fuel Filter with bushing (40) Fuel Filter with bushing (55/60/70)
30	Rubber Bushing
31	PCB Support
32	Ignition Control Assembly
33	Fuel Cap (Includes Gasket) Fuel Gauge (Includes Gasket) RM60 Only, If Equipped
34	Fuel Tank (40) Fuel Tank (55/60/70) Fuel Tank (RM60 Only, if Equipped with Fuel Gauge)
35	Shell Heat-Shield
36	Thermostat
37	Screw, #8-32 x 7/8"
38	Thermostat Knob
39	Lock Washer, EXT #8

Motor and Pump Assembly

ALL-PRO LOW PRESSURE

MODEL	MOTOR	TRANSFORMER/ IGNITION CONTROL/ IGNITOR	SAFETY/ FLAME-OUT CONTROL	FAN	SPARK PLUG/ HSI	INTAKE FILTER KIT	OUTPUT FILTER KIT	NOZZLE	PHOTO CELL	ROTOR KIT - ROTOR, BLADES, INSERT	FUEL FILTER KIT	PUMP ADJ. KIT	T-STAT KIT
PK55	10200128	10404001	NA	10368401	*L PP200 *R PP201	PP213	PP213	PP219	PP236	PP205	M5087605	PP217	FA1210
PK60	10200128	10404001	NA	10368401	*L PP200 *R PP201	PP213	PP213	PP219	PP234	PP205	M5087605	PP217	FA1210
PK70T	NLA	10404001	NA	NLA	PP200	PP213	PP213	PP220	PP236	PP205	M5087605	PP217	FA1210
PK110	10200130	10404001	NA	09729301	PP200	M12179	M122441	PP221	PP236	PP204	NLA	PP217	FA1210
PK115T	10200130	10404001	NA	09729301	PP200	M12179	M122441	PP221	PP236	PP204	NLA	PP217	FA1210
PK165T	10200130	10404001	NA	10204201	PP200	M12179	M122441	PP222	PP236	PP204	NLA	PP217	FA1210
PKHD170T	10200130	11347101	NA	10204201	PP200	M12179	M122441	PP223	PP236	PP205	NLA	PP217	FA1210
PKHD200T	10518301	11347101	NA	10204201	PP200	M12179	M122441	PP235	PP236	PP205	NLA	PP217	FA1210

MASTER LOW PRESSURE

MODEL	MOTOR	TRANSFORMER/ IGNITION CONTROL/ IGNITOR	SAFETY/ FLAME-OUT CONTROL	FAN	SPARK PLUG/ HSI	INTAKE FILTER KIT	OUTPUT FILTER KIT	NOZZLE	PHOTO CELL	ROTOR KIT - ROTOR, BLADES, INSERT	FUEL FILTER KIT	PUMP ADJ. KIT	T-STAT KIT
B30	NLA	10248202	PP203	NLA	PP200	PP213	PP213	NLA	PP216	PP204	M5087601	PP217	FA1210
B30C	NLA	10248202	NLA	NLA	PP200	PP213	PP213	NLA	PP216	PP204	M5087601	PP217	FA1210
B50	NLA	NLA	PP203	NLA	PP200	NLA	NLA	NLA	PP216	PP204	NLA	PP217	FA1210
B50A	NLA	10248202	PP203	NLA	*L PP200	PP213	PP213	NLA	PP216	PP204	M5087601	PP217	FA1210
B50B	NLA	10248202	PP203	NLA	*R PP201	PP213	PP213	NLA	PP216	PP204	NLA	PP217	FA1210
/B50D/ = ROUND	NLA	NLA	PP203	NLA	PP200	NLA	NLA	NLA	PP216	PP204	M5087602	PP217	FA1210
/B50D/ = SQUARE	10200128	10248202	PP203	NLA	PP213	PP213	PP213	PP207	PP216	PP204	M5087602	PP217	FA1210
B50E	10200128	10248202	PP203	NLA	PP211	PP213	PP213	PP207	PP216	PP204	M5087602	PP217	FA1210
B50F	10200128	10248202	PP203	NLA	PP211	PP213	PP213	PP207	PP216	PP204	M5087602	PP217	FA1210
B50G	10200128	10248202	PP203	NLA	PP211	PP213	PP213	NLA	PP216	PP205	M5087602	PP217	FA1210
B50H	10200128	10404001	NA	NLA	PP211	PP213	PP213	NLA	PP236	PP205	M5087602	PP217	FA1210
B50J	10200128	10404001	NA	10368401	NLA	PP213	PP213	PP219	PP236	PP205	M5087605	PP217	FA1210
B55	10200128	10404001	NA	10368401	PP211	PP213	PP213	PP219	PP236	PP205	M5087605	PP217	FA1210
B55BT	10200128	10404001	NA	10368401	PP211	PP213	PP213	PP219	PP236	PP205	M5087605	PP217	FA1210
B55CT	10200128	10404001	NA	10368401	PP200	PP213	PP213	PP219	PP236	PP205	M5087605	PP217	FA1210
B60	10200128	10404001	NA	10368401	*L PP200	PP213	PP213	PP219	PP236	PP205	M5087605	PP217	FA1210
BV60S	NLA	10248202	PP203	NLA	*R PP201	PP215	PP215	NLA	PP216	PP204	PP215	PP217	FA1210
B65	NLA	NLA	PP203	NLA	NLA	NLA	NLA	NLA	PP216	PP204	M19630	PP217	FA1210
B65D	NLA	NLA	PP203	NLA	NLA	NLA	NLA	NLA	PP216	PP204	M19630	PP217	FA1210
=B66D=ROUND	NLA	10248202	PP203	NLA	NLA	PP213	PP213	NLA	PP216	PP204	M19630	PP217	FA1210
=B66D=SQUARE	NLA	10248202	PP203	NLA	NLA	PP215	PP215	NLA	PP216	PP204	PP215	PP217	FA1210
B70	NLA	NLA	PP211	NLA	PP211	NLA	NLA	NLA	NLA	NLA	NLA	PP217	FA1210
B70B	09730805	10248202	PP203	M5110701	PP211	PP213	PP213	NLA	PP216	PP204	M5087605	PP217	FA1210
B70BT	09730805	10248202	PP203	M5110701	PP211	PP213	PP213	NLA	PP216	PP204	M5087605	PP217	FA1210
B70D	NLA	10404001	NA	NLA	PP211	PP213	PP213	PP220	PP236	PP204	M5087605	PP217	FA1210
B70DT	NLA	10404001	NA	10368401	PP211	PP213	PP213	PP220	PP236	PP204	M5087605	PP217	FA1210
B70ET	NLA	10404001	NA	NLA	PP211	PP213	PP213	PP220	PP236	PP204	M5087605	PP217	FA1210
B75	NLA	NLA	PP211	NLA	PP211	NLA	NLA	NLA	NLA	NLA	NLA	PP217	FA1210
B80	NLA	NLA	NLA	NLA	PP211	NLA	NLA	NLA	NLA	NLA	NLA	PP217	FA1210
B90	NLA	NLA	NLA	NLA	PP200	NLA	NLA	NLA	NLA	NLA	NLA	PP217	FA1210
(B99)	NLA	NLA	NLA	NLA	PP211	M12179	M122441	NLA	NLA	PP204	NLA	PP217	FA1210
(B99)	NLA	10248202	NLA	NLA	PP201	PP215	PP215	NLA	PP216	PP204	PP215	PP217	FA1210
B99D	NLA	10248202	PP203	NLA	PP200	M12179	M122441	NLA	PP216	PP204	NLA	PP217	FA1210
B100	NLA	10248202	PP203	NLA	PP200	M12179	M122441	NLA	PP216	PP204	NLA	PP217	FA1210
B100AAK	07950503	10248202	PP203	M5115301	PP211	PP214	PP214	PP209	PP216	PP204	PP214	PP217	FA1210
B100A	07950503	10248202	NLA	M5115301	PP200	PP214	PP214	PP209	PP216	PP204	PP214	PP217	FA1210
B100B	07950503	10248202	NLA	M5115301	PP200	PP214	PP214	PP209	PP216	PP204	PP214	PP217	FA1210
B100D	NLA	10248202	NLA	NLA	PP200	PP215	PP215	NLA	PP216	PP204	PP215	PP217	FA1210
B100G	07950503	10248202	PP203	M5115301	PP211	PP214	PP214	PP209	PP216	PP204	PP214	PP217	FA1210
B100KD	07950503	10248202	PP203	NLA	PP215	PP215	PP215	NLA	PP216	PP204	PP215	PP217	FA1210
M100VT	10200130	10404001	NA	09729301	PP211	M12179	M122441	NLA	PP236	PP204	NLA	PP217	FA1210
B110	07950503	10248202	PP203	09729301	PP211	PP214	PP214	PP209	PP216	PP204	PP214	PP217	FA1210
B110A	07950503	NLA	NA	09729301	PP200	PP214	PP214	PP209	PP236	PP204	PP214	PP217	FA1210
B110B	10200130	10404001	NA	09729301	PP201	PP214	PP214	PP221	PP236	PP204	PP214	PP217	FA1210
B110BT	10200130	10404001	NA	09729301	PP211	PP214	PP214	PP221	PP236	PP204	PP214	PP217	FA1210
B110T	07950503	10248202	PP203	09729301	PP200	PP214	PP214	PP209	PP236	PP204	PP214	PP217	FA1210
B115	10200130	10404001	NA	09729301	PP211	PP214	PP214	PP221	PP236	PP204	PP214	PP217	FA1210
B115DT	10200130	10404001	NA	09729301	PP211	M12179	M122441	PP221	PP236	PP204	NLA	PP217	FA1210
B115T	10200130	NLA	NA	09729301	PP211	PP214	PP214	PP221	PP236	PP204	PP214	PP217	FA1210
BC100	NLA	10248202	NLA	NLA	PP211	M12179	M122441	NLA	PP216	PP204	NLA	PP217	FA1210

MASTER LOW PRESSURE (cont'd)

MODEL	MOTOR	TRANSFORMER/ IGNITION CONTROL/ IGNITOR	SAFETY/ FLAME-OUT CONTROL	FAN	SPARK PLUG/ HSI	INTAKE FILTER KIT	OUTPUT FILTER KIT	NOZZLE	PHOTO CELL	ROTOR KIT - ROTOR, BLADES, INSERT	FUEL FILTER KIT	PUMP ADJ. KIT	T-STAT KIT
B120	07999402	NLA	PP203	NLA	PP211	M12179	M122441	NLA	PP216	NLA	NLA	PP217	FA1210
BV125	07999402	10248202	PP203	NLA	PP211	M12179	M122441	NLA	PP216	NLA	NLA	PP217	FA1210
BV125S	07999402	10248202	PP203	NLA	PP211	M12179	M122441	NLA	PP216	NLA	NLA	PP217	FA1210
M125T	10200130	10404001	NA	09729301	PP211	M12179	M122441	PP221	PP236	PP204	NLA	PP217	FA1210
M125AT	10200130	10404001	NA	09729301	PP211	M12179	M122441	PP221	PP236	PP204	NLA	PP217	FA1210
B140/D	07999402	10248202	PP203	NLA	PP211	PP215	PP215	PP210	PP216	NLA	PP215	PP217	FA1210
M140VT	10200130	NLA	NA	10204201	PP201	M12179	M122441	NLA	PP236	PP204	NLA	PP217	FA1210
B150	07999402	10248202	PP203	NLA	PP200	PP215	PP215	PP210	PP216	NLA	PP215	PP217	FA1210
B150A	07999402	10248202	PP203	NLA	PP200	PP215	PP215	PP210	PP216	NLA	PP215	PP217	FA1210
B150B	07999402	10248202	PP203	NLA	PP211	PP215	PP215	PP210	PP216	PP204	PP215	PP217	FA1210
B150C	07999402	10248202	PP203	NLA	PP211	PP215	PP215	PP210	PP216	PP204	PP215	PP217	FA1210
B150CAK	07999402	10248202	PP203	NLA	PP200	PP215	PP215	PP210	PP216	PP204	PP215	PP217	FA1210
B150D	07999402	10248202	PP203	NLA	PP212	PP215	PP215	PP210	PP216	NLA	PP215	PP217	FA1210
B150F	07950503	10248202	PP203	09729301	PP212	PP214	PP214	PP210	PP216	PP204	PP214	PP217	FA1210
B150FT	07950503	10248202	PP203	09729301	PP211	PP214	PP214	PP210	PP216	PP204	PP214	PP217	FA1210
B150GT	07950503	10248202	PP203	09729301	PP212	PP214	PP214	PP210	PP216	PP204	PP214	PP217	FA1210
B150G	07950503	10248202	PP203	09729301	PP212	PP214	PP214	PP210	PP216	PP204	PP214	PP217	FA1210
B150H	07950503	NLA	NA	09729301	PP211	PP214	PP214	PP210	PP236	PP204	PP214	PP217	FA1210
B150J	10200130	10404001	NA	10204201	PP212	PP214	PP214	PP222	PP236	PP204	PP214	PP217	FA1210
B150JT	10200130	10404001	NA	10204201	PP212	PP214	PP214	PP222	PP236	PP204	PP214	PP217	FA1210
B150KD	07999402	10248202	PP203	NLA	PP212	PP215	PP215	PP210	PP216	NLA	PP215	PP217	FA1210
B150M	NLA	NLA	&	09729301	PP212	PP214	PP214	PP210	NLA	PP204	PP214	PP217	FA1210
B155T	10200130	10404001	NA	10204201	PP200	PP214	PP214	PP222	PP236	PP204	PP214	PP217	FA1210
B155CT	10200130	10404001	NA	09729301	PP200	M12179	M122441	PP222	PP236	PP204	NLA	PP217	FA1210
B155DT	10200130	10404001	NA	09729301	PP200	M12179	M122441	PP222	PP236	PP204	NLA	PP217	FA1210
B165	10200107	10248202	PP203	NLA	PP211	PP214	PP214	NLA	PP216	PP204	PP214	PP217	FA1210
B165A	10200130	10404001	NA	10204201	PP200	PP214	PP214	PP223	PP236	PP204	PP214	PP217	FA1210
B165CT	10200130	10404001	NA	10204201	PP200	M12179	M122441	PP223	PP236	PP204	NLA	PP217	FA1210
B165DT	10200130	10404001	NA	10204201	PP200	M12179	M122441	PP222	PP236	PP204	NLA	PP217	FA1210
M170T	10200130	10404001	NA	10204201	PP200	M12179	M122441	PP223	PP236	PP204	NLA	PP217	FA1210
M170AT	10200130	10404001	NA	10204201	PP200	M12179	M122441	PP223	PP236	PP205	NLA	PP217	FA1210
M200T	10518301	10404001	NA	10204201	PP200	M12179	M122441	PP235	PP236	PP205	NLA	PP217	FA1210
M200AT	10518301	10404001	NA	10204201	PP200	M12179	M122441	PP235	PP236	PP205	NLA	PP217	FA1210
M200VT	10518301	10404001	NA	10204201	PP200	PP214	PP214	PP235	PP236	PP205	PP214	PP217	FA1210
B165AT	10200130	10404001	NA	10204201	PP200	PP214	PP214	PP223	PP236	PP204	PP214	PP217	FA1210
B165T	10200107	10248202	PP203	NLA	PP211	PP214	PP214	NLA	PP216	PP204	PP214	PP217	FA1210
B200	10200107	10248202	PP203	10204201	PP211	PP214	PP214	PP235	PP216	PP205	PP214	PP217	FA1210
B200T	10200107	10248202	PP203	10204201	PP211	PP214	PP214	PP235	PP216	PP205	PP214	PP217	FA1210
B200AT	10518301	10404001	NA	10204201	PP200	PP214	PP214	PP235	PP236	PP205	PP214	PP217	FA1210
B200BT	10518301	10404001	NA	10204201	PP200	PP214	PP214	PP235	PP236	PP205	PP214	PP217	FA1210

REDDY LOW PRESSURE

MODEL	MOTOR	TRANSFORMER/ IGNITION CONTROL/ IGNITOR	SAFETY/ FLAME-OUT CONTROL	FAN	SPARK PLUG/ HSI	INTAKE FILTER KIT	OUTPUT FILTER KIT	NOZZLE	PHOTO CELL	ROTOR KIT - ROTOR, BLADES, INSERT	FUEL FILTER KIT	PUMP ADJ. KIT	T-STAT KIT
M30	NLA	10248202	PP203	NLA	PP212	PP213	PP213	NLA	PP216	PP204	M5087601	PP217	FA1210
R30	10200128	10248202	PP203	NLA	PP212	PP213	PP213	NLA	PP216	PP204	M5087604	PP217	FA1210
R35	10200128	10248202	PP203	NLA	PP212	PP213	PP213	PP206	PP216	PP204	M5087604	PP217	FA1210
R35A	10200128	10248202	PP203	NLA	PP212	PP213	PP213	PP206	PP216	PP204	M5087604	PP217	FA1210
R35B	10200128	10248202	PP203	NLA	PP212	PP213	PP213	PP206	PP216	PP204	M5087604	PP217	FA1210
R35D	10200128	10404001	NA	NLA	PP200	PP213	PP213	PP206	PP236	PP204	M5087604	PP217	FA1210
R35E	10200128	10404001	NA	10368401	PP200	PP213	PP213	PP206	PP236	PP204	M5087605	PP217	FA1210
R40	10200128	10404001	NA	10368401	PP200	PP213	PP213	PP206	PP236	PP204	M5087605	PP217	FA1210
R40T	10200128	10404001	NA	10368401	PP200	PP213	PP213	PP206	PP236	PP204	M5087604	PP217	FA1210
Mini Furn.	NLA	NLA	NLA	NLA	PP211	NLA	NLA	NLA	PP216	PP204	M19630	PP217	FA1210
Mark 50	NLA	NLA	PP203	NLA	PP211	NLA	NLA	NLA	PP216	PP204	NLA	PP217	FA1210
Mark 50D	NLA	NLA	PP203	NLA	PP211	NLA	NLA	NLA	PP216	PP204	NLA	PP217	FA1210
M50	NLA	10248202	PP203	NLA	PP212	PP213	PP213	NLA	PP216	PP204	M5087601	PP217	FA1210
M50A	NLA	10248202	PP203	NLA	PP211	PP215	PP215	NLA	PP216	PP204	M19630	PP217	FA1210
M50D	NLA	10248202	PP203	NLA	PP212	PP213	PP213	NLA	PP216	PP204	M5087601	PP217	FA1210
M50S	NLA	10248202	PP203	NLA	PP211	PP215	PP215	NLA	PP216	PP204	PP215	PP217	FA1210
R50	10200128	10248202	PP203	NLA	PP212	PP213	PP213	PP207	PP216	PP204	M5087602	PP217	FA1210
R50A	10200128	10248202	PP203	NLA	PP212	PP213	PP213	PP207	PP216	PP204	M5087602	PP217	FA1210
R50B	10200128	10248202	PP203	NLA	PP212	PP213	PP213	PP207	PP216	PP204	M5087602	PP217	FA1210
R50BT	10200128	10404001	NA	10368401	PP200	PP213	PP213	PP219	PP236	PP205	M5087605	PP217	FA1210

NLA - No Longer Available
NA - Not Applicable

*R - Round Hot Surface Ignitor
*L - "L" shaped Hot Surface Ignitor

*M - Fuel tanks w/a metal filler neck
*P - Fuel tanks w/a plastic filler neck

HA1180 Pressure Gauge Kit (fits all)
HA2210 Filler Neck Accessory (fits all)

REDDY LOW PRESSURE (cont'd)

MODEL	MOTOR	TRANSFORMER/ IGNITION CONTROL/ IGNITOR	SAFETY/ FLAME-OUT CONTROL	FAN	SPARK PLUG/ HSI	INTAKE FILTER KIT	OUTPUT FILTER KIT	NOZZLE	PHOTO CELL	ROTOR KIT - ROTOR, BLADES, INSERT	FUEL FILTER KIT	PUMP ADJ. KIT	T-STAT KIT
R55	10200128	10248202	PP203	NLA	PP212	PP213	PP213	NLA	PP216	PP205	M5087605	PP217	FA1210
R55A	10200128	10404001	NA	NLA	PP200	PP213	PP213	NLA	PP236	PP205	M5087605	PP217	FA1210
R55B	10200128	10404001	NA	10368401	PP200	PP213	PP213	PP219	PP236	PP205	M5087605	PP217	FA1210
R55BT	10200128	10404001	NA	10368401	PP200	PP213	PP213	NLA	PP236	PP205	M5087605	PP217	FA1210
R55M	NLA	NLA	NA	NLA	PP212	PP213	PP213	NLA	PP205	PP205	M5087605	PP217	FA1210
R60	10200128	10404001	NA	10368401	PP200	PP213	PP213	PP219	PP236	PP205	M5087605	PP217	FA1210
R60A	10200128	10404001	NA	10368401	*L PP200 *R PP200	PP213	PP213	PP219	PP236	PP205	M5087605	PP217	FA1210
RM60	10200128	10404001	NA	10368401	PP200	PP213	PP213	PP219	PP236	PP205	M5087605	PP217	FA1210
MC60	NLA	10248202	NLA	NLA	PP211	M12179	M122441	NLA	NLA	PP204	NLA	PP217	FA1210
M65	NLA	NLA	PP203	NLA	PP211	NLA	NLA	NLA	PP216	PP204	M19630	PP217	FA1210
M65D	NLA	NLA	PP203	NLA	PP211	NLA	NLA	NLA	PP216	PP204	M19630	PP217	FA1210
=M66D=ROUND	NLA	10248202	PP203	NLA	PP211	PP213	PP213	NLA	PP216	PP204	M19630	PP217	FA1210
=M66D=SQUARE	NLA	10248202	PP203	NLA	PP211	PP215	PP215	NLA	PP216	PP204	PP215	PP217	FA1210
Mark75D	NLA	NLA	PP203	NLA	NLA	M12179	M122441	NLA	PP216	PP204	NLA	PP217	FA1210
R70	09730805	10248202	PP203	M5110701	PP211	PP213	PP213	NLA	PP216	PP204	M5087605	PP217	FA1210
R70A	09730805	10248202	PP203	M5110701	PP211	PP213	PP213	NLA	PP216	PP204	M5087605	PP217	FA1210
R70B	09730805	10248202	PP203	M5110701	PP211	PP213	PP213	NLA	PP216	PP204	M5087605	PP217	FA1210
R70AT	09730805	10248202	PP203	M5110701	PP211	PP213	PP213	NLA	PP216	PP204	M5087605	PP217	FA1210
R70BT	09730805	10248202	PP203	M5110701	PP211	PP213	PP213	NLA	PP216	PP204	M5087605	PP217	FA1210
R70CT	09730805	10248202	PP203	M5110701	PP211	PP213	PP213	NLA	PP216	PP204	M5087605	PP217	FA1210
R70DT	NLA	10404001	NA	10368401	PP200	PP213	PP213	PP220	PP236	PP204	M5087605	PP217	FA1210
R70ET	NLA	10404001	NA	NLA	PP200	PP213	PP213	PP220	PP236	PP204	M5087605	PP217	FA1210
R70D	NLA	10404001	NA	NLA	PP200	PP213	PP213	PP220	PP236	PP204	M5087605	PP217	FA1210
R75	NLA	NLA	NLA	NLA	NLA	NLA	NLA	NLA	NLA	NLA	NLA	PP217	FA1210
M85	NLA	10248202	PP203	NLA	PP211	PP215	PP215	NLA	PP216	PP204	PP215	PP217	FA1210
M85D	NLA	10248202	PP203	NLA	PP211	PP215	PP215	NLA	PP216	PP204	PP215	PP217	FA1210
M100	NLA	10248202	PP203	NLA	PP211	PP215	PP215	NLA	PP216	PP204	PP215	PP217	FA1210
M100D	NLA	10248202	PP203	NLA	PP211	PP215	PP215	NLA	PP216	PP204	PP215	PP217	FA1210
R100	07950503	10248202	NLA	M5115301	PP211	PP214	PP214	PP209	PP216	PP204	PP214	PP217	FA1210
R100A	07950503	10248202	PP203	M5115301	PP211	PP214	PP214	PP209	PP216	PP204	PP214	PP217	FA1210
R100B	07950503	10248202	PP203	M5115301	PP211	PP214	PP214	PP209	PP216	PP204	PP214	PP217	FA1210
RH100VT	10200130	10404001	NA	09729301	PP200	M12179	M122441	NLA	PP236	PP204	NLA	PP217	FA1210
R110	07950503	10248202	PP203	09729301	PP211	PP214	PP214	PP209	PP216	PP204	PP214	PP217	FA1210
R110A	07950503	NLA	NA	09729301	PP201	PP214	PP214	PP209	PP236	PP204	PP214	PP217	FA1210
R110C	10200130	10404001	NA	09729301	PP200	PP214	PP214	PP221	PP236	PP204	PP214	PP217	FA1210
R110B	10200130	10404001	NA	09729301	PP200	PP214	PP214	PP221	PP236	PP204	PP214	PP217	FA1210
R110BT	10200130	10404001	NA	09729301	PP200	PP214	PP214	PP221	PP236	PP204	PP214	PP217	FA1210
R110M3	07950503	NLA	NA	09729301	PP211	PP214	PP214	PP209	PP236	PP204	PP214	PP217	FA1210
R115	10200130	10404001	NA	09729301	PP200	PP214	PP214	PP221	PP236	PP204	PP214	PP217	FA1210
R115C	10200130	10404001	NA	09729301	PP200	M12179	M122441	PP221	PP236	PP204	NLA	PP217	FA1210
R115DT	10200130	10404001	NA	09729301	PP200	M12179	M122441	PP221	PP236	PP204	NLA	PP217	FA1210
R115T	10200130	10404001	NA	09729301	PP200	PP214	PP214	PP221	PP236	PP204	PP214	PP217	FA1210
RM115	10200130	10404001	NA	09729301	PP200	PP214	PP214	PP221	PP236	PP204	PP214	PP217	FA1210
Mark120D	07999402	NLA	PP203	NLA	NLA	M12179	M122441	NLA	PP216	NLA	NLA	PP217	FA1210
RH125T	10200130	10404001	NA	09729301	PP200	M12179	M122441	PP221	PP236	PP204	NLA	PP217	FA1210
RH125AT	10200130	10404001	NA	09729301	PP201	M12179	M122441	PP221	PP236	PP204	NLA	PP217	FA1210
RHD125T	10200130	10404001	NA	09729301	PP200	M12179	M122441	PP221	PP236	PP204	NLA	PP217	FA1210
RL125AT	10200130	11347101	N/A	09729301	PP201	M12179	M122441	PP221	PP236	PP204	NLA	PP217	FA1210
RL125T	10200130	10404001	NA	09729301	PP200	M12179	M122441	PP221	PP236	PP204	NLA	PP217	FA1210
RE125T	10200130	10404001	NA	09729301	PP200	M12179	M122441	PP221	PP236	PP204	NLA	PP217	FA1210
Mark140D	07999402	NLA	PP203	NLA	NLA	M12179	M122441	NLA	PP216	NLA	NLA	PP217	FA1210
RH140VT	10200130	10404001	NA	10204201	PP200	M12179	M122441	NLA	PP236	PP204	NLA	PP217	FA1210
M150D	07999402	10248202	PP203	NLA	PP211	PP215	PP215	PP210	PP216	NLA	PP215	PP217	FA1210
M150S	07999402	10248202	PP203	NLA	PP211	PP215	PP215	PP210	PP216	NLA	PP215	PP217	FA1210
R150	07999402	10248202	PP203	NLA	PP211	PP215	PP215	PP210	PP216	PP204	PP215	PP217	FA1210
R150A	07999402	102482-02	PP203	NLA	PP211	PP215	PP215	PP210	PP216	PP204	PP215	PP217	FA1210
R150B	07950503	10248202	PP203	09729301	PP211	PP214	PP214	PP210	PP216	PP204	PP214	PP217	FA1210
R150AT	07999402	10248202	PP203	NLA	PP211	PP215	PP215	PP210	PP216	PP204	PP215	PP217	FA1210
R150BT	07950503	10248202	PP203	09729301	PP211	PP214	PP214	PP210	PP216	PP204	PP214	PP217	FA1210
R150BT	07950503	10248202	PP203	09729301	PP211	PP214	PP214	PP210	PP216	PP204	PP214	PP217	FA1210
R150D	07950503	10248202	PP203	09729301	PP211	PP214	PP214	PP210	PP216	PP204	PP214	PP217	FA1210
R150E	07950503	NLA	NA	09729301	PP201	PP214	PP214	PP210	PP236	PP204	PP214	PP217	FA1210
R150M	NLA	NLA	NA	09729301	PP211	PP214	PP214	PP210	NLA	PP204	PP214	PP217	FA1210
R150M2	07950503	NLA	NA	09729301	PP211	PP214	PP214	PP210	PP236	PP204	PP214	PP217	FA1210
MS80	NLA	NLA	NLA	NLA	NLA	M12179	M122441	NLA	NLA	NLA	NLA	PP217	FA1210
Mark150D	07999402	10248202	PP203	NLA	PP211	M12179	M122441	PP210	PP216	NLA	NLA	PP217	FA1210

REDDY LOW PRESSURE (cont'd)

MODEL	MOTOR	TRANSFORMER/ IGNITION CONTROL/ IGNITOR	SAFETY/ FLAME-OUT CONTROL	FAN	SPARK PLUG/ HSI	INTAKE FILTER KIT	OUTPUT FILTER KIT	NOZZLE	PHOTO CELL	ROTOR KIT - ROTOR, BLADES, INSERT	FUEL FILTER KIT	PUMP ADJ. KIT	T-STAT KIT
R155	07950503	10248202	PP203	09729301	PP211	PP214	PP214	PP210	PP216	PP204	PP214	PP217	FA1210
R155A	07950503	NLA	NA	09729301	PP201	PP214	PP214	PP210	PP236	PP204	PP214	PP217	FA1210
R155B	10200130	10404001	NA	10204201	PP200	PP214	PP214	PP222	PP236	PP204	PP214	PP217	FA1210
R155C	10200130	10404001	NA	09729301	PP200	M12179	M122441	PP222	PP236	PP204	NLA	PP217	FA1210
R155D	10200130	10404001	NA	09729301	PP200	M12179	M122441	PP222	PP236	PP204	NLA	PP217	FA1210
RM155	10200130	10404001	NA	10204201	PP200	PP214	PP214	PP222	PP236	PP204	PP214	PP217	FA1210
R165	10200107	10248202	PP203	NLA	PP211	PP214	PP214	NLA	PP216	PP204	PP214	PP217	FA1210
R165A	10200130	10404001	NA	10204201	PP200	PP214	PP214	PP223	PP236	PP204	PP214	PP217	FA1210
R165T	10200107	10248202	PP203	NLA	PP211	PP214	PP214	NLA	PP216	PP204	PP214	PP217	FA1210
R165AT	10200130	10404001	NA	10204201	PP200	PP214	PP214	PP223	PP236	PP204	PP214	PP217	FA1210
R165CT	10200130	10404001	NA	10204201	PP200	M12179	M122441	PP222	PP236	PP204	NLA	PP217	FA1210
R165DT	10200130	10404001	NA	10204201	PP200	M12179	M122441	PP222	PP236	PP204	NLA	PP217	FA1210
RH170T	10200130	10404001	NA	10204201	PP200	M12179	M122441	PP223	pp 236	PP204	NLA	PP217	FA1210
RH170AT	10200130	10404001	NA	10204201	PP200	M12179	M122441	PP223	PP236	PP205	NLA	PP217	FA1210
RHD170T	10200130	10404001	NA	10204201	PP200	M12179	M122441	PP223	PP236	PP204	NLA	PP217	FA1210
RE170T	10200130	10404001	NA	10204201	PP200	M12179	M122441	PP223	PP236	PP204	NLA	PP217	FA1210
RL170T	10200130	10404001	NA	10204201	PP200	M12179	M122441	PP223	PP236	PP204	NLA	PP217	FA1210
RL170AT	10200130	11347101	N/A	10204201	PP200	M12179	M122441	PP223	PP236	PP205	NLA	PP217	FA1210
R200	10200107	10248202	PP203	10204201	PP211	PP214	PP214	PP235	PP216	PP205	PP214	PP217	FA1210
R200A	10518301	10404001	NA	10204201	PP200	PP214	PP214	PP235	PP236	PP205	PP214	PP217	FA1210
R200BT	10518301	10404001	NA	10204201	PP200	PP214	PP214	PP235	PP236	PP205	PP214	PP217	FA1210
RM200T	10200107	10248202	PP203	10204201	PP211	PP214	PP214	PP235	PP216	PP205	PP214	PP217	FA1210
RM200AT	10518301	10404001	NA	10204201	PP200	PP214	PP214	PP235	PP236	PP205	PP214	PP217	FA1210
RE200T	10518301	10404001	NA	10204201	PP200	PP214	PP214	PP235	PP236	PP205	PP214	PP217	FA1210
RH200VT	10518301	10404001	NA	10204201	PP200	PP214	PP214	PP235	PP 236	PP205	PP214	PP217	FA1210
RHD200VT	10518301	10404001	NA	10204201	PP200	PP214	PP214	PP235	PP236	PP205	PP214	PP217	FA1210
RHD200T	10518301	10404001	NA	10204201	PP200	M12179	M122441	PP235	PP 236	PP205	NLA	PP217	FA1210
TA100	NLA	NLA	N/A	NLA	NLA	PP213	PP213	NLA	NLA	PP204	NLA	PP217	FA1210
TA101	NLA	NLA	N/A	NLA	NLA	PP213	PP213	NLA	NLA	PP205	NLA	PP217	FA1210

REMINGTON LOW PRESSURE

MODEL	MOTOR	TRANSFORMER/ IGNITION CONTROL/ IGNITOR	SAFETY/ FLAME-OUT CONTROL	FAN	SPARK PLUG/ HSI	INTAKE FILTER KIT	OUTPUT FILTER KIT	NOZZLE	PHOTO CELL	ROTOR KIT - ROTOR, BLADES, INSERT	FUEL FILTER KIT	PUMP ADJ. KIT	T-STAT KIT
REM35	10200128	10248202	PP203	NLA	PP212	PP213	PP213	PP206	PP216	PP204	M5087604	PP217	FA1210
REM35A	10200128	10248202	PP203	NLA	PP212	PP213	PP213	PP206	PP216	PP204	M5087604	PP217	FA1210
REM35B	10200128	10404001	NA	NLA	PP200	PP213	PP213	PP206	PP236	PP204	M5087604	PP217	FA1210
REM35C	10200128	10404001	NA	10368401	PP200	PP213	PP213	PP206	PP236	PP204	M5087604	PP217	FA1210
REM40	10200128	10404001	NA	10368401	PP200	PP213	PP213	PP206	PP236	PP204	M5087602	PP217	FA1210
REM50	10200128	10248202	PP203	NLA	PP212	PP213	PP213	PP207	PP216	PP204	M5087602	PP217	FA1210
REM50A	10200128	10248202	PP203	NLA	PP212	PP213	PP213	PP207	PP216	PP204	M5087602	PP217	FA1210
REM50B	10200128	10248202	PP203	NLA	PP212	PP213	PP213	NLA	PP216	PP205	M5087602	PP217	FA1210
REM50C	10200128	10404001	NA	NLA	PP200	PP213	PP213	NLA	PP236	PP205	M5087602	PP217	FA1210
REM55	10200128	10248202	PP203	NLA	PP212	PP213	PP213	NLA	PP216	PP205	M5087605	PP217	FA1210
REM55A	10200128	10404001	NA	NLA	PP200	PP213	PP213	NLA	PP236	PP205	M5087605	PP217	FA1210
REM55B	10200128	10404001	NA	10368401	PP200	PP213	PP213	PP219	PP236	PP205	M5087605	PP217	FA1210
REM55-W	10200128	10248202	PP203	NLA	PP212	PP213	PP213	NLA	PP216	PP205	M5087605	PP217	FA1210
REM60	10200128	10404001	NA	10368401	PP200	PP213	PP213	PP219	PP236	PP205	M5087605	PP217	FA1210
REM100	07950503	10248202	PP203	M5115301	PP211	PP214	PP214	PP209	PP216	PP204	PP214	PP217	FA1210
REM100A	07950503	10248202	PP203	M5115301	PP211	PP214	PP214	PP209	PP216	PP204	PP214	PP217	FA1210
REM110	07950503	10248202	PP203	09729301	PP211	PP214	PP214	PP209	PP216	PP204	PP214	PP217	FA1210
REM110A	07950503	10248202	NA	09729301	PP201	PP214	PP214	PP209	PP236	PP204	PP214	PP217	FA1210
REM110B	10200130	10404001	NA	09729301	PP200	PP214	PP214	PP221	PP236	PP204	PP214	PP217	FA1210
REM110BT	10200130	10404001	NA	09729301	PP200	PP214	PP214	PP221	PP236	PP204	PP214	PP217	FA1210
REM115	10200130	10404001	NA	09729301	PP200	PP214	PP214	PP221	PP236	PP204	PP214	PP217	FA1210
REM115T	10200130	10404001	NA	09729301	PP200	PP214	PP214	PP221	PP236	PP204	PP214	PP217	FA1210
REM150	07999402	10248202	PP203	NLA	PP211	PP215	PP215	PP210	PP216	PP204	PP215	PP217	FA1210
REM150A	07950503	10248202	PP203	09729301	PP211	PP214	PP214	PP210	PP216	PP204	PP214	PP217	FA1210
REM150B	07950503	10248202	PP203	09729301	PP211	PP214	PP214	PP210	PP216	PP204	PP214	PP217	FA1210
REM150D	07950503	NLA	NA	09729301	PP201	PP214	PP214	PP210	PP236	PP204	PP214	PP217	FA1210
REM150E	10200130	10404001	NA	10204201	PP200	PP214	PP214	PP222	PP236	PP204	PP214	PP217	FA1210
REM155	07950503	10248202	PP203	09729301	PP211	PP214	PP214	PP210	PP216	PP204	PP214	PP217	FA1210
REM155A	07950503	NLA	NA	09729301	PP201	PP214	PP214	PP210	PP236	PP204	PP214	PP217	FA1210
REM155B	10200130	10404001	NA	10204201	PP200	PP214	PP214	PP222	PP236	PP204	PP214	PP217	FA1210
REM165	10200107	10248202	PP203	NLA	PP211	PP214	PP214	NLA	PP216	PP204	PP214	PP217	FA1210
REM200T	10200107	10248202	PP203	10204201	PP211	PP214	PP214	PP235	PP216	PP205	PP214	PP217	FA1210
REM200AT	10518301	10404001	NA	10204201	PP200	PP214	PP214	PP235	PP236	PP205	PP214	PP217	FA1210
REM200	10200107	10248202	PP203	10204201	PP211	PP214	PP214	PP235	PP216	PP205	PP214	PP217	FA1210

NLA - No Longer Available
NA - Not Applicable

*R - Round Hot Surface Ignitor
*L - "L" shaped Hot Surface Ignitor

*M - Fuel tanks w/a metal filler neck
*P - Fuel tanks w/a plastic filler neck

HA1180 Pressure Gauge Kit (fits all)
HA2210 Filler Neck Accessory (fits all)